

Vehicle Safety Recall - Technical Service Bulletin

PROMPT ACTION REQUIRED

Attention: McNeilus Product Owner
Subject: Mixer Vertical Chute Rack for Steel or Aluminum Chutes
Models Affected: All Mixers
Date: May 2014

Purpose:

McNeilus Truck and Manufacturing, Inc. has decided that a concern affecting safety exists in some vertical chute racks. The vertical chute rack can allow extension chutes to unexpectedly detach from the rack while in transport. The result of chutes detaching from the vehicle creates a possibility of a road hazard, which could result in a vehicle crash or injury. In the interest of motor safety and customer satisfaction, McNeilus has elected to initiate a voluntary recall to allow us to formally recall all affected units. This remedy must be completed on all affected units.

Affected Vehicles:

The affected vehicle population is McNeilus Mixers equipped with vertical chute racks for steel or aluminum chutes, produced between 10/25/13 and 2/14/14 (plus one unit on 2/24/14). Please refer to the attached VIN list of affected vehicles. (The chute racks for composite chutes and paver chutes are not affected.)

Time Completion

The time of accomplishment may vary due to a number of factors; however, the estimated time for completion of the procedure is 1.0 hour under normal circumstances.

Required Action:

1. Review and verify your ownership of all affected serial numbers of McNeilus mixers provided on the enclosed VIN list. Please be reminded that it is a violation of Federal law for you to sell or lease the mixers covered by this notification until this recall has been performed on these vehicles. Substantial civil penalties apply to violations of this law.

Reimbursement of Costs:

Affected units shall be repaired using the customer’s own qualified service technicians - at no cost to the owner. The repairs should take approximately 1.0 hour.

Please contact McNeilus to submit a warranty claim. In order to receive credit, you must provide McNeilus Warranty with either photographic evidence that the part(s) to be replaced is destroyed (cut in two pieces), or you must return the part to McNeilus Truck and Manufacturing, Inc. (obtain an RGA form from McNeilus Warranty prior to return).

Labor Reimbursement:

Claims are to be submitted through the warranty claim system. Claims must be received within 30 days of the repair. Claims must include the McNeilus serial number, the customer asset number, and this bulletin’s number (VSR-TSB-003).

Parts Reimbursement:

Parts and ground shipping will be reimbursed to the customer. Parts necessary for this repair must be ordered from McNeilus Parts by emailing: **chuteracks@mcneilusco.com**.

In the email, you must provide the following information:

1. List which trucks (by Mixer Serial Number or Chassis VIN) you are updating through this bulletin.
2. Shipping address for the parts.
3. Quantity of parts, listed by part number.
4. Paint code, if known.

Claims are to be submitted through the warranty claim system. Claims must be received within 30 days of the repair. Claims must include the McNeilus serial number, the customer asset number, and this bulletin’s number (VSR-TSB-003).

Contacts:

If you have questions or need further information, please contact a National Service Representative at 1-888-686-7278.

Enclosures:

Mixer Vertical Chute Rack and Chute Stop Inspection and Replacement Procedure
VIN List of Affected Vehicles

SAFETY NOTICE
<p>Before entering the Mixer drum or performing any maintenance to the Mixer, read and follow OSHA Regulations concerning entry and working in “CONFINED SPACE” OSHA 1910.146 and “LOCKOUT/TAGOUT” OSHA 1910.147.</p> <p>Follow OSHA Regulations while performing any work to the Mixer.</p> <p>Follow all safety instructions in your McNeilus Mixer Manual.</p> <p>Shut off truck engine, lock cab doors, and keep keys in your pocket before entering drum, or performing any work to the Mixer.</p> <p>Place magnetic “DANGER” signs on both cab doors. Failure to do so can result in serious personal injury or death.</p> <p>If you have any questions regarding this notice or require further assistance, call McNeilus Truck and Manufacturing, Inc. at 888-686-7278.</p>

Vertical Chute Rack and Chute Stop Inspection and Replacement Procedure

Tools and Equipment Required (Customer to supply own):

- Standard mechanic tools (see procedures for specific sizes)

Parts Required (provided by McNeilus):

Ref. No.	Part Number	Description	Qty.
1	1503879	BRKT, VERT, 3 CHUTE, STD, WLDT	1
	1164989	SCR, FLG, HEX .62-11 X 2.00 G8 ZY	4
	0120202	NUT, LOCK, FLG HEAD, .62-11 GG CW	4
2	1504170	BRKT, VERT, 2 CHUTE, STD, WLDT	1
	1164989	SCR, FLG, HEX .62-11 X 2.00 G8 ZY	4
	0120202	NUT, LOCK, FLG HEAD, .62-11 GG CW	4
3	1503170	STOP, CHUTE HANGER, R PED, WLDT	1
	1243670	SCR, FLG, HEX .38-16 x 2.00 G8 ZY	4
	0120200	NUT, FLG, LKDT .38-16 GG CW	4

NOTE: The cable does not need replacing. Retain and use the cable with the replacement chute rack.

Procedure 1: Inspect the Chute Rack and Chute Stop:

1. Place unit on a flat surface and block truck tires. Follow all Lockout/Tagout procedures.
2. Inspect the vertical chute rack to determine if the following procedure is necessary. The inspection procedure applies to either the two chute rack design or the three chute rack design:
 - If the chute rack looks like Figure 1, the rack is acceptable and no action is required (“old” chute rack style). The truck may be returned to service. (Note: Images for both the two chute rack design and the three chute rack design are provided.)
 - If the chute rack looks like Figure 2, the rack must be replaced (“recalled” chute rack style). (Note: Images for both the two chute rack design and the three chute rack design are provided.)
 - An obvious difference between the old chute rack style and the recalled chute rack style is that the recalled chute rack has two bent tabs on the bottom rack (Figure 2).
 - Follow the rest of the procedure to replace the recalled rack (Procedure 2) and inspect the chute stop.



Figure 1: “Old” Style Chute Rack **does not need to be replaced**. On left is the three chute rack design, and on the right is the two chute rack design.

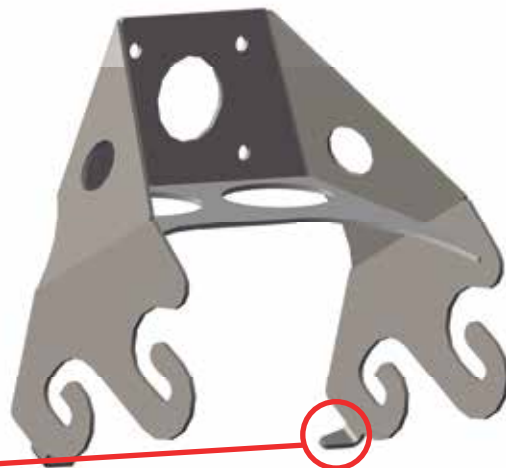
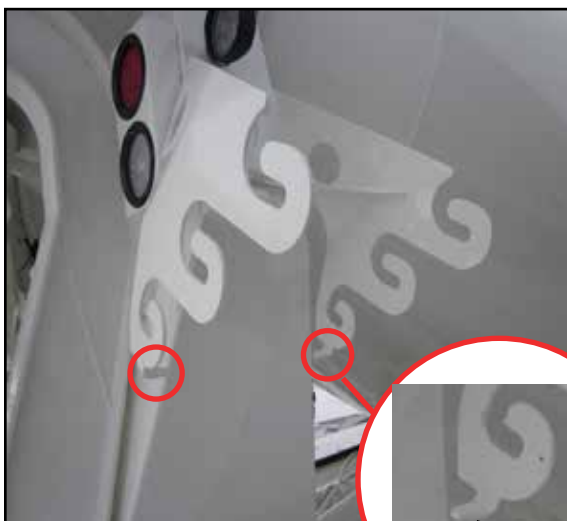

Figure 2: “Recalled” Style Chute Rack **must be replaced**. On left is the three chute rack design, and on the right is the two chute rack design.

Figure 3 shows the NEW style chute rack designs (1503879 or 1504170) that will replace the “recalled” designs.

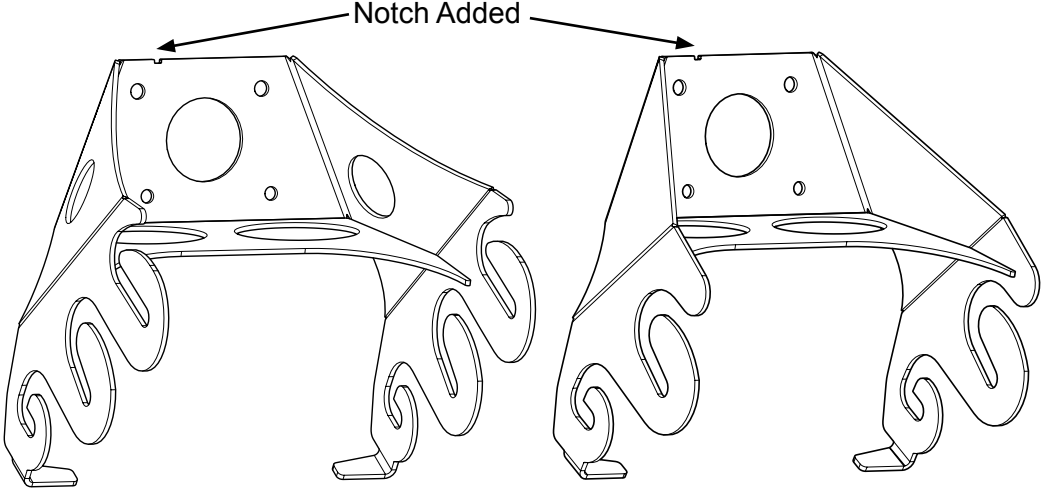

Figure 3: NEW chute rack designs (1503879 for the 3 chute design, 1504170 for the 2 chute design).

3. If the chute rack must be replaced, inspect the rack for an offset style chute stop.
 - If the rack has an offset style chute stop (Figure 4), the chute stop must also be replaced. See Procedure 3 for more information to replace the offset chute stop.
 - If the rack has a straight style chute stop (Figure 5), then the chute stop does not need replacing.



Figure 4: Offset Style Chute Stop must be replaced.



*Figure 5: Straight Style Chute Stop **does not** need to be replaced.*

Procedure 2: Replace the Chute Rack

1. Remove the existing chute rack from the truck by removing the mounting hardware. Provide McNeilus Warranty with either photographic evidence that the existing chute rack and mounting hardware are destroyed (cut in two pieces), or you must return the existing chute rack and mounting hardware to McNeilus Truck and Manufacturing, Inc. (obtain an RGA form from McNeilus Warranty prior to return).
2. Install and align the new chute rack, **P/N 1504170 for the two chute rack design** or **P/N 1503879 for the three chute rack design**, on the truck in the same location from which you removed the existing chute rack.
3. Secure the new chute rack on the truck using the new hardware provided: (4) P/N 1164989 Bolts, (4) P/N 0120202 Nuts. See Figure 6 for securing location of the chute rack on the truck (the three chute rack design is shown in Figure 6 for illustrative purposes. Install and attach P/N 1504170 for the two chute rack design in the same manner).

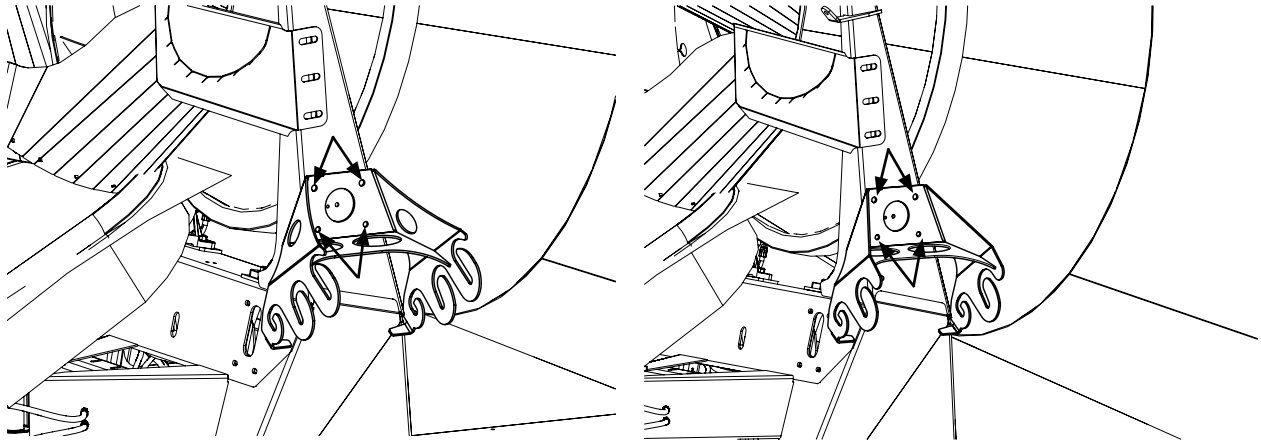

Figure 6: Place and secure the new chute rack on to the truck with the provided hardware. On left is the three chute rack design, and on the right is the two chute rack design.

Procedure 3: Replace the Offset Chute Stop

If you need to replace the offset chute stop, follow these instructions.

1. Remove the existing offset chute stop by removing the mounting hardware that secures the chute stop to the truck. Discard the existing chute stop and hardware.
2. Install and align the new offset chute stop (P/N 1503170) on the truck in the same location from which you removed the existing chute stop (Figure 7).
3. Secure with the new hardware provided: (4) P/N 1243670 Bolts, (4) P/N 0120200 Nuts (Figure 7).

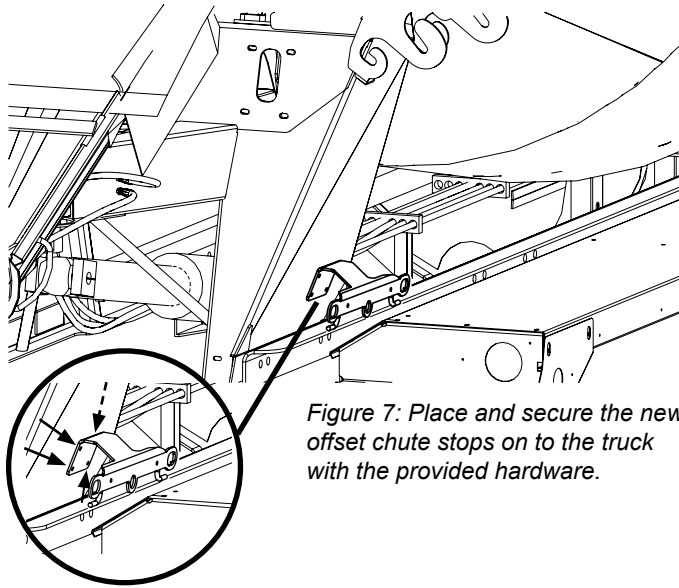

Figure 7: Place and secure the new offset chute stops on to the truck with the provided hardware.

Continuous Improvement:

The change included in this bulletin is part of the McNeilus® Continuous Improvement Process.

McNeilus® Company's quality policy is Providing Customer Satisfaction through Innovative Products, Dedicated Service, and a constant focus on Continuous Improvement.

"The Customer is our Boss!"



(888) 686-7278

www.streetsmartparts.com

**One Number. One Call.
One Solution.**

VSR-TSB-003 VIN List
(NHTSA 14V-135)

1M2AX04C3EM020372	1FVMG3CY4EHFY2152	1M2AX04C9EM020232
1M2AX04C1EM020452	1FVMG3CY6EHFY2153	1M2AX04C0EM020233
1M2AX04C3EM020453	1FVMG3CY8EHFY2154	1M2AX04C2EM020234
1NKWL70X8EJ409838	1FVMG3CYXEHFY2155	1M2AX04C4EM020235
1NKWL70XXEJ409839	1FVMG3CY1EHFY2156	1NKWLPOX4EJ415569
1M2AX04C5EM020549	1FVMG3CY3EHFY2157	1NKWLPOX0EJ415570
1M2AX04C1EM020550	1FVMG3CY5EHFY2158	1M2AX04C7EM020228
1M2AX04C3EM020551	1FVMG3CY7EHFY2159	1M2AX04C9EM020229
1M2AX04C5EM020552	1FVMG3CY3EHFY2160	1NKWL70X2EJ413416
1M2AX04C7EM020553	1FVMG3CY5EHFY2161	1M2AX04C6EM021032
1M2AX04C9EM020554	1FVMG3CY7EHFY2162	1M2AX04C8EM021033
1M2AX04C0EM020555	1NPSLPEX2ED242036	1M2AX04CXEM021034
1M2AX04C2EM020556	1NPSLPEX4ED242037	1M2AX04C1EM021035
1M2AX04C4EM020557	1NPSLPEX6ED242038	1M2AX04C3EM021036
1M2AX04C6EM020558	1NPSLPEX8ED242039	1M2AX04C5EM021037
1M2AX04C8EM020559	1NPSLPEX4ED242040	1M2AX04C7EM021038
1M2AX04C4EM020560	1NPSLPEX6ED242041	1M2AX04C9EM021039
1M2AX04C6EM020561	1NPSLPEX8ED242042	1M2AX04C5EM021040
1M2AX04CXEM020563	1NKWXPEX1EJ415106	1M2AX04C7EM021041
1M2AX13C7EM026313	1NKWXPEX3EJ415107	1NKWLPOX2EJ415571
1M2AX13C9EM026314	1NKWXPEX5EJ415108	1NKDX7EX8ER417492
1M2AX13C0EM026315	1NKWXPEX7EJ415109	1NKDX7EX4FR417510
1M2AX13C2EM026316	1NKWXPEX3EJ415110	1NKWL70X3EJ418334
1M2AX13C4EM026317	1NKWXPEX5EJ415111	1NKWL70X5EJ418335
3ALHGNDV7EDFV0786	1NKWXPEX7EJ415112	1NKWL70X7EJ418336
1NPSXJ0X4ED234075	1NKWXPEX9EJ415113	1NKWL70X9EJ418337
1NPSXJ0X6ED234076	1NKWXPEX0EJ415114	1NKWL70X0EJ418338
4V5KC9DG8EN175120	1NKWXPEX2EJ415115	1NKWL70X2EJ418339
4V5KC9DGXEN175121	1NKWXPEX4EJ415116	1NKWL70X9EJ418340
1NPSL70X0ED175220	1NKWXPEX6EJ415117	1NKWL70X0EJ418341
1NPSL70X2ED175221	1NKWXPEX8EJ415118	1NKWL70X2EJ418342
1NPSL70X4ED175222	1NKWXPEXXEJ415119	1NKWL70X4EJ418343
1NKWL70X9EJ409301	1NKWXPEX6EJ415120	1NKWL70X6EJ418344
1NKWL70X0EJ409302	1NKWXPEX8EJ415121	1NKWL70X8EJ418345
1NKWL70X2EJ409303	1NKWL20X1EJ416178	1NKWL70X4EJ418570
1NKWL70X4EJ409304	1M2AX04C1EM020225	1NKWL70X6EJ418571
1M2AX04C9EM020456	1M2AX04C3EM020226	1NKWL70X1EJ418560
1M2AX04C0EM020457	1M2AX04C5EM020227	1NKWL70X1FJ418561
1M2AX04C0EM020426	1M2AX04C9EM021106	1NKWL70X7EJ418563
1FVMG3CY5EHFY2144	1M2AX04C0EM021107	1NKWL70X7FJ418564
1FVMG3CY7EHFY2145	1NKWLJ0X7EJ415465	1NKWL70X9FJ418565
1FVMG3CY9EHFY2146	1NKWLJ0X9EJ415466	1NKWL70X0FJ418566
1FVMG3CY0EHFY2147	1NKWLJ0X0EJ415467	1NKWL70X2FJ418567
1FVMG3CY2EHFY2148	1NKWLJ0X2EJ415468	1NKWL70X4FJ418568
1FVMG3CY4EHFY2149	1NKWLJ0X4EJ415469	1NKWL70X6FJ418569
1FVMG3CY0EHFY2150	1NKWLJ0X0EJ415470	1NKWLPOX1EJ418137
1FVMG3CY2EHFY2151	1M2AX04C7EM020231	1NKWLPOX3EJ418138

VSR-TSB-003 VIN List
(NHTSA 14V-135)

1NKWLP0X5EJ418139	1NKWXPEX4EJ419411
1NKWL70X2EJ401010	1NKWXPEXXEJ419395
1NKWL70X4EJ401008	1NKWXPEX6EJ419412
1NKWL70X6EJ401009	1NKWXPEX8EJ419394
1NKWL70X7EJ404887	1NKWXPEXXEJ419400
1NKWL70X9EJ404888	1NKWXPEX0EJ419406
1NKWL70X2EJ386380	1NKWXPEX0FJ419410
1NPSXJEX3ED250258	1NKWL70X4EJ417273
1NPSXJEX5ED250259	1NKWL70X6EJ417274
1NKWL70X6EJ409305	1NKWL70X0EJ416427
1NKWL70X7EJ393762	1NPSL70X4ED176001
1NPSLJ0X1ED178933	1M2AX04C5EM020633
1FVHG3DV1EHFV7456	1M2AX04C7EM020634
1FVHG3DV3EHFV7457	1M2AX04C0EM020636
1M2AX03C7EM021090	1M2AX04C2EM020637
1M2AX03C8EM021194	4V5KC9DF4FN183434
1M2AX03CXEM021195	3ALMG3DV0EDFZ1280
1M2AX03C1EM021196	1NKWL70X0EJ417268
1M2AX03C3EM021197	1NKWL70X2EJ417272
1M2AX03C5EM021198	1M2AX04C8EM020562
1NPSXJEX1ED250260	1M2AX04C5EM020230
1NPSXJEX3ED250261	1M2AX04C6EM021080
1M2AX04C1EM021018	1M2AX04C8EM021081
1NPSL70X1ED175226	1M2AX04CXEM021082
1NPSL70X3ED175227	1M2AX04C1EM021083
1NP7L7EX7FD253670	
1NPSLPEX6FD253672	
1NPSL70X3ED228637	
1NPSL70X7ED228639	
1NPSL70X0ED251857	
1NPSL70X0FD251858	
1M2AX04C4EM020428	
1M2AX04C6EM020429	
1NKWXPEX0EJ419390	
1NKWXPEX2EJ419391	
1NKWXPEX4EJ419392	
1NKWXPEX6EJ419393	
1NKWXPEX1EJ419396	
1NKWXPEX5EJ419398	
1NKWXPEX7EJ419399	
1NKWXPEX1EJ419401	
1NKWXPEX3EJ419402	
1NKWXPEX5EJ419403	
1NKWXPEX7EJ419404	
1NKWXPEX9EJ419405	
1NKWXPEX2EJ419407	
1NKWXPEX4EJ419408	