

Mixer Lower Ladder Platform Weld Inspection

Date: 06-09-15
Bulletin Name: MXR-TSB-024
Model: Mixer
Affected Units: Bridgemaster V Mixer and Standard Mixer

Purpose:

McNeilus Truck and Manufacturing requires the inspection of mixer lower ladder platform welds on Bridgemaster V Mixers and Standard Mixers. A vendor manufactured lower ladder platform may not have been manufactured with all the necessary welds. The amount of weld currently on the platform is enough to be structurally sound. However, if the welds are not present, McNeilus requires the ladder platform be replaced because of the possibility of corrosion on an unwelded platform. There is no affect to driving capabilities of the Mixer vehicle.

Notice:

- This bulletin should be read and understood in its entirety before performing this procedure.
- All procedures outlined in the bulletin must be performed by skilled service personnel. Refer to the product service manual for descriptions of maintenance procedures.

SAFETY NOTICE

Before entering the Mixer drum or performing any maintenance to the Mixer, read and follow OSHA Regulations concerning entry and working in “CONFINED SPACE” OSHA 1910.146 and “LOCKOUT/TAGOUT” OSHA 1910.147.

Follow OSHA Regulations while performing any work to the Mixer.

Follow all safety instructions in your McNeilus Mixer Manual.

Shut off truck engine, lock cab doors, and keep keys in your pocket before entering drum, or performing any work to the Mixer.

Place magnetic “DANGER” signs on both cab doors. Failure to do so can result in serious personal injury or death.

If you have any questions regarding this notice or require further assistance, call McNeilus at 888-686-7278.

Tools and Equipment Required (Customer to supply own):

- Wrench
- Torque wrench

Parts Required (provided by McNeilus):

Item	Part Number	Description	Qty.
1	1109058	LOWER LADDER PLATFORM	1
2	1164981	SCR, FLG, HEX .50- 13X1.75 G8 ZY	2
3	1164982	SCR, FLG, HEX .50-13X2.25 G8 ZY	2
4	0120201	NUT, FLG, LKDT .50-13 GG CW	4
5	1164986	SCR, FLG, HEX .50-13X4.00 G8 ZY	2
6	0120254	NUT, JAM, .50-13 GA ZC	2

Procedure for Inspection of the Lower Ladder Platform Welds:

1. Place unit on a flat surface, block truck tires, and observe all conditions of the Safety Notice concerning Lockout/Tagout posted in the Notice section of this bulletin.
2. Locate the areas of the possibly missing welds (see Figure 1 for the location of the ladder platform. See Figure 2 for location of missing welds on the lower ladder platform).
 - If the welds are missing, order a new lower ladder platform by calling McNeilus Parts at 888-686-7278. Once you receive a new platform, follow the Procedure for Lower Ladder Platform Installation in this bulletin for installation instructions.
 - If the welds are in place, this bulletin is complete. Remove the conditions of Lockout/Tagout and return the vehicle to service.

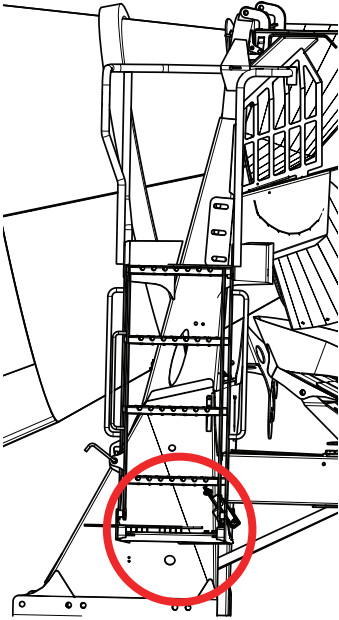

Figure 1: Locate the lower ladder platform.



Figure 2: Locations of missing welds.

Procedure for Lower Ladder Platform Installation:

This procedure will require the use of two people.

The existing lower ladder platform must be removed and discarded.

- The platform is secured to the upper ladder by (2) bolts and (2) nuts, to the lower ladder by (2) bolts and (2) nuts, and to the rear platform by (2) bolts and (2) nuts.
1. Place unit on a flat surface, block truck tires, and observe all conditions of the Safety Notice concerning Lockout/Tagout posted in the Notice section of this bulletin.
 2. Lower the fold-down ladder. While the second person is holding up the platform and holding onto the fold-down ladder, the first person should remove and discard the front (4) bolts and (4) nuts from the platform on the **ladder side** (see Figure 3 which shows removal from one side only).

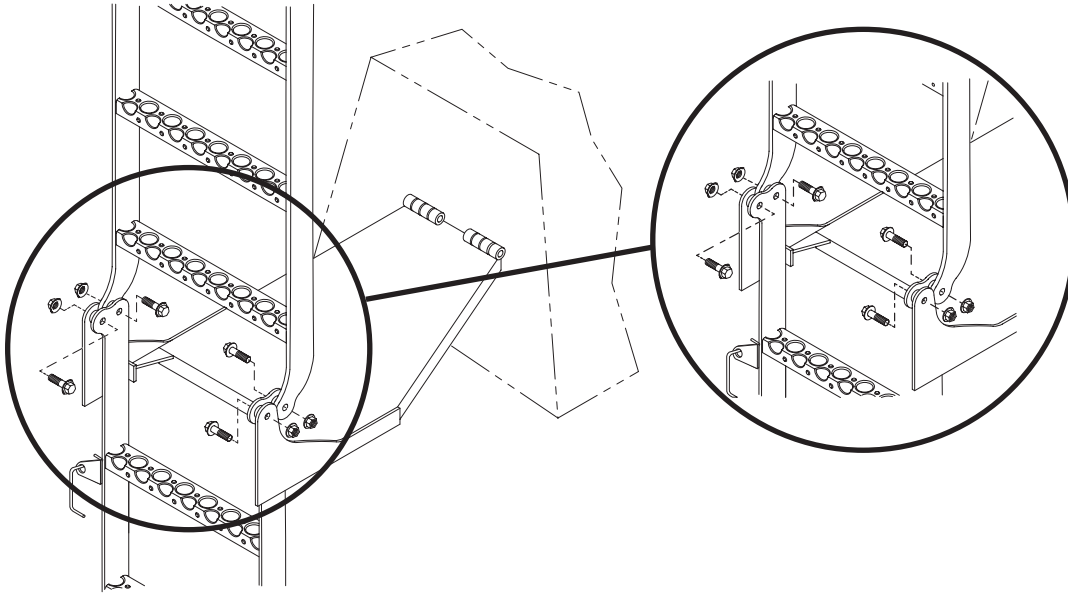

Figure 3: Remove and discard the (4) bolts and (4) nuts from the ladder side of the platform.

3. The fold-down ladder is now free from the lower ladder platform and the platform is not connected to the upper ladder. Set the ladder aside.

4. Remove and discard the bolts and nuts from the platform on the rear pedestal end (see Figure 4).

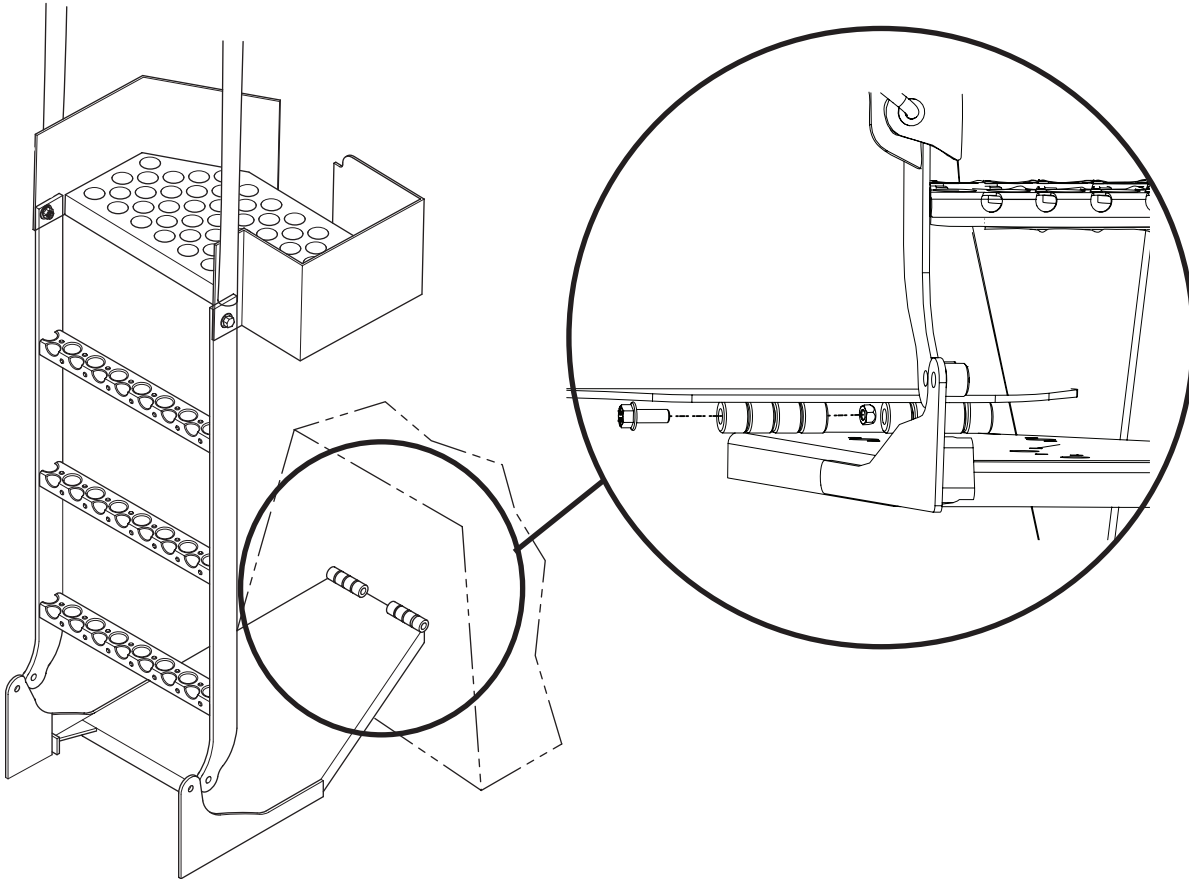

Figure 4: Remove and discard the (2) bolts and (2) nuts from the rear pedestal side of the platform. Only one side shown here.

5. Remove and discard the existing lower ladder platform. (See the warranty reimbursement section of this bulletin and step 12 for specific instructions before discarding the existing platform.)
6. Install the new lower ladder platform (P/N 1109058) by first having the second person hold it in place.
7. Install the new (2) bolts and (2) nuts to secure the platform to the rear pedestal (see Figure 5 - only one side shown for illustrative purposes).

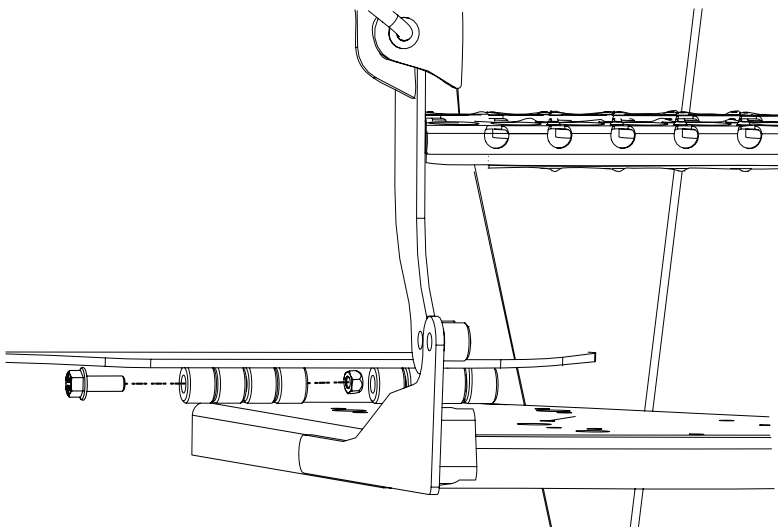

Figure 5: Install the (2) bolts and (2) nuts to secure the new platform to the rear pedestal side. Only one side shown.

8. Line up the fold-down ladder to the lower ladder platform and upper ladder as shown in Figure 6. The second person should hold both the fold-down ladder and the new platform for steps 9 and 10.
9. Install the new (4) bolts and (4) nuts to secure the platform to the ladder (see Figure 6).

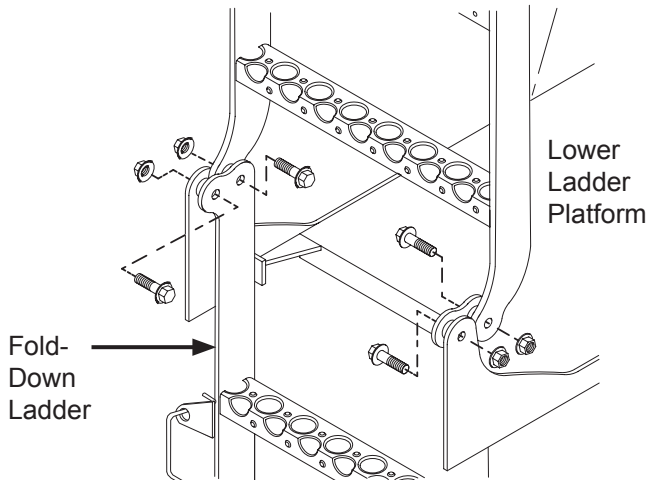

Figure 6: Install the new (4) bolts and (4) nuts to secure the platform to the ladder side.

10. Use a torque wrench to torque the bolts to 80 ft-lbs.
11. Installation of the lower ladder platform is complete. Remove the conditions of Lockout/Tagout and return vehicle to service.
12. Follow the normal warranty claim process, which includes providing McNeilus Warranty photo evidence that the original lower ladder platform **did not** have the proper welds.

Contact McNeilus® For Warranty:

McNeilus should be contacted to submit a warranty claim.

- **Parts Reimbursement** - Parts necessary for this update need to be ordered from McNeilus Parts. Claims are to be submitted through the warranty claim system. Claims must be received within 30 days of the repair. Claim must include the McNeilus serial number of the Mixer, the customer asset number, and the number of this bulletin.
- **Labor Reimbursement** - Claims are to be submitted through the warranty claim system. Claims must be received within 30 days of the repair. Claim must include the McNeilus serial number of the Mixer, the customer asset number, and the number of this bulletin.

Labor Reimbursement: 2 Hours

Deadline:

If required, this service update should be performed at the earliest opportunity. The following terms must be met to qualify for reimbursement cost.

- For reimbursement, a warranty claim form with proof of installation must be submitted by: **December 9, 2015**

Continuous Improvement:

The change included in this bulletin is part of the McNeilus® Continuous Improvement Process.

McNeilus® Company's quality policy is Providing Customer Satisfaction through Innovative Products, Dedicated Service, and a constant focus on Continuous Improvement.

"The Customer is our Boss!"



(888) 686-7278

www.streetsmartparts.com

MXR-TSB-024 VIN List

1M2AX18C2FM029825	1NPSLJ0X8FD290730	1M2AX04C8FM023818
1M2AX18C0FM029824	1NPSLJ0X1FD290732	1M2AX04C6FM023820
1M2AX13C9FM028744	1NPSLJ0X2FD290738	1M2AX04CXFM023822
1M2AX13C5FM028742	1NPSLJ0X2FD290741	1M2AX04C8FM023821
1M2AX13C7FM028743	1NPSLJ0X7FD290749	1M2AX18C9FM029756
1M2AX13C0FM028745	1NPSLJ0X4FD290742	1M2AX13C1FM029323
1M2AX13C8FM028749	1NPSLJ0X9FD290753	1M2AX13C5FM029325
1M2AX13C4FM028747	1NPSLJ0X5FD290748	1NKZLP0X5FJ457456
1M2AX13C4FM028750	1NKWL70X2FJ448698	1NKZLP0X7FJ457457
1M2AX13C2FM028746	1NKWL70X0FJ448697	1NKZLP0X0FJ457459
1M2AX13CXFM030129	1M2AX13C8FM029416	1NKZLP0X9FJ457458
1NKWL70X6FJ448008	1M2AX13C1FM029953	1NKZLP0X9FJ457461
1NKWL70X8FJ448009	1M2AX13C9FM029487	1NKZLP0X7FJ457460
3ALMG3CY1FDGM7532	1M2AX13C0FM029488	1FVHG3DV9FHGN1408
3ALMG3CY4FDGM7539	1M2AX13C2FM029489	1NPSLJ0XXFD278689
1NPSLJ0X3FD289954	1M2AX13C9FM029490	1NPSLJ0XXFD278692
1NPSLJ0XXFD289949	1M2AX13C0FM029491	1NPSLJ0X6FD278690
1NPSLJ0XXFD289952	1M2AX13C4FM029896	1NKZL70X2FJ448701
1NPSLJ0X1FD289953	1NKZL70X3FJ448707	1NKZL70X6FJ448703
1NPSLJ0X6FD289950	1NKZL70XXFJ448705	1NKZL70X8FJ448704
1NPSLP0X3FD282375	1NKZL0X7FJ454980	1NKZL70X0FJ452925
1NPSLP0X5FD282376	1NPSLH0X6FD285647	1M2AX13C5FM029602
1NKWL70X3FJ454963	1NPSLH0X8FD285648	1NPSL70X5FD279655
1NKWL70X5FJ454964	1M2AX13C7FM029665	1NPSL70X0FD277957
1NKWL70X7FJ454965	1M2AX13C1FM029659	1NPSL70X7FD279656
1NKWL70X0FJ454967	1M2AX13CXFM029658	1NPSL70X0FD279658
1NKWL70X9FJ454966	1M2AX13C8FM029660	1NPSL70X9FD279657
1NPSL70X8FD285787	1M2AX13C1FM029662	1NPCL70X8FD288547
1NPSL70X2FD285784	1M2AX13C9FM029666	1M2AX04C9FM023827
1NPSL70X1FD285789	1M2AX13CXFM029661	1M2AX13C6FM029950
1NPSL70X8FD285790	1M2AX13C0FM029667	1NPCL70X6FD288546
1NPSL70XXFD285788	1M2AX13C3FM029663	5KKHAVDV0FPGJ1926
1NPSL70X1FD285792	1M2AX13C5FM029664	5KKHAVDV9FPGJ1925
1NPSL70X4FD285785	1M2AX13C2FM029668	1NPSLJ0X9FD278697
1NKWLJ0X7FJ449276	1M2AX13C4FM029669	1M2AX13C4FM029316
1NKWL70X4FJ454938	1M2AX04C0FM024140	1M2AX13C2FM029315
1NKWL70X6FJ454939	3ALHG3CY5FDGL9337	1M2AX13C3FM029324
1NKWLJ0X1FJ449273	3ALHG3CY5FDGL9340	1NKWL70X4FJ451859
1NKWLJ0X3FJ449274	3ALHG3CY9FDGL9339	
1NKWLJ0X2FJ449279	1M2AX13C3FM029744	
1NKWL70X6FJ448686	1M2AX13C1FM029743	
1NKWLJ0X9FJ449280	1M2AX12C2FM029610	
1NKWLJ0X2FJ449282	1NKWL70X0FJ448683	
1NKWLJ0X0FJ449281	1NKWL70X4FJ448685	
1NPSLP0X1FD282374	1NKWL70X0FJ451860	
1NPSLJ0XXFD290728	3HTXYSNTXFN678103	
1NPSLJ0X1FD290729	1M2AX04C4FM023816	